

PACKAGING



**VSE 30**  
Thermoforming packaging machine

# Thermoforming packaging – Smart concept.

Hajek Benefits

## Control cabinet

- Special mounting of control cabinet
- Separate mounting plate for film holder and operating terminal
- Efficient software and sensor system
- Maximum level of diagnostic options
- Intelligent safety shutdown

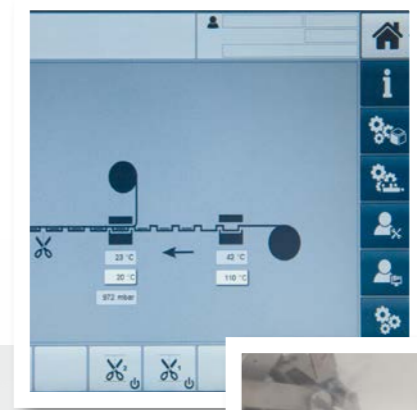
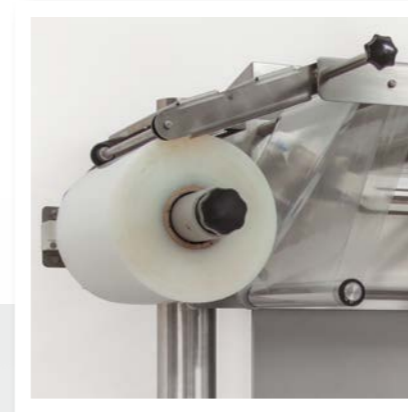

## Touch screen panel on swivelling arm

- Very easy operating philosophy
- Detailed error diagnosis
- USB / Ethernet interface
- Up to 500 recipes can be saved
- Individual access rights



## Film change

Optimised and simple film change



## Discharge conveyor

Standardised and customised discharge and separation systems

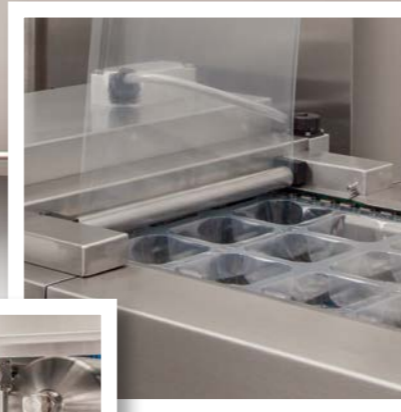

## Cutting systems

For customized special packages



## Sealing

- Optimised, easy and quick tool change
- High level of packaging safety
- High sealing pressures

## Hygienic design

- Stainless steel construction
- Machine frame and side elements are made of stainless steel based on the latest hygienic requirements
- The side elements can be removed easily or opened in cleaning mode
- The three-dimensional welded modules feature maximum stiffness and can be cleaned easily at the connecting points

EASY TO OPERATE

MAINTANANCE FRIENDLY

# Opening aids

## Peel corner



### Standard

Easy opening of packages through loose/unsealed upper film tab. The customised sealing seam is set back slightly.



### With raised bumps

Easy opening of packages through loose/unsealed upper film tab which is lifted a little by the raised bump. The customised sealing seam is set back slightly.

## Tear-open tab

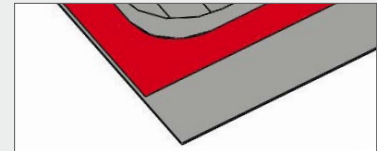

### Standard

Easy opening of a package through a loose/unsealed tear-open tab running over the entire width of the package.

## Peel corner with bottom web deformation

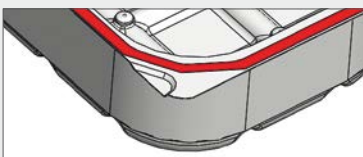

### Standard

Reaching in or under the upper film makes opening of packages easier. The customised sealing seam is set back slightly.

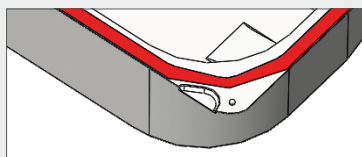

### With raised bumps

Reaching in or under the upper foil makes opening of packages easier. To further improved opening of packages, raised bumps support the lifting of the unsealed upper film. The customised sealing seam is also set back slightly.

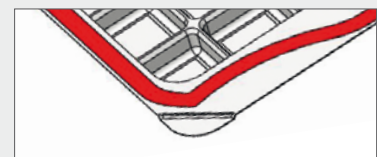

### Special applications

Customer-specific requirements in the opening aid area, incl. the sealing seam are possible.

## Bottom film corner cut



### Skin application

The corner section of the bottom film is sealed with the upper film. During opening, the bottom film supports opening through better grip of the corner. Suitable for skin applications.

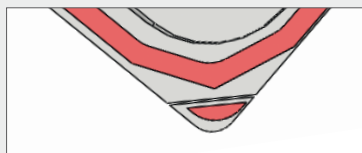

### Standard

The corner section of the bottom film is sealed with the upper film at selected points. During opening, the bottom foil supports opening through better grip of the corner.

## Jagged cut



### Standard

Easy tearing or tearing open of the package at the jags.

# Product samples

## Food-Vakuu-MAP-SKIN



## Nonfood



## Medicine



## Technical data

<b>Machine length</b>	Depending on machine configuration			
<b>Nominal machine width (mm)</b>	285 – 320 – 355 – 420 – 459 – 520 – 560 – 620 Special widths available on request			
<b>Index length (mm)</b>	200-600			
<b>Forming depth (mm)</b>	≤ 150			
<b>Performance</b>	≤ 15 cycles/min.			
<hr/>				
<b>Film</b>	<b>Material</b>	<b>Printed</b>	<b>Diameter (mm)</b>	<b>Core</b>
bottom	flexible, semi-rigid	option	≤ 400	3" (standard)
top	flexible, semi-rigid	option	≤ 400	6" (optional)
<hr/>				
<b>Voltage</b>	3 x 400 V 50 Hz – with neutral wire and protective conductor			
<b>Compressed air (bar)</b>	6-10			
<b>Cooling water (bar)</b>	1,5-4,5			



GPS Reisacher GmbH & Co. KG  
Gewerbegebiet Thal  
Hinter den Gärten 8  
87730 Bad Grönenbach  
Germany  
info@hajek-engineering.com  
www.hajek-engineering.com

Hajek and GPS Reisacher  
are registered trademarks of  
GPS Reisacher GmbH & Co. KG.